

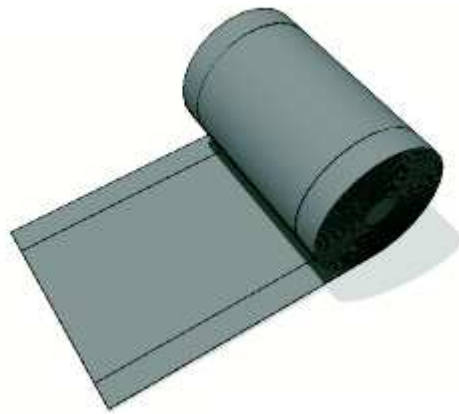

MAPAL DRAINAGE GUTTER SYSTEM INSTALLATION GUIDE

DRAINAGE GUTTER 6.5-22-6.5

THE DRAINAGE GUTTER ARRIVES IN ROLLS



UNROLL THE DRAINAGE GUTTER TO THE DESIRED LENGTH
ADDING AN ADDITIONAL 13 CM FOR FOLDING AT THE ENDS

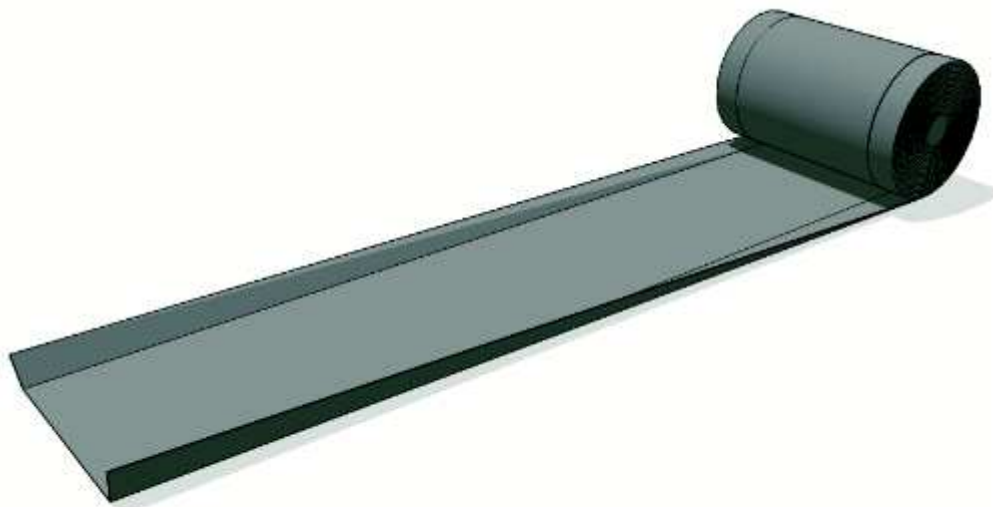

DO THE NECESSARY FOLDS AT THE END OF THE DRAINAGE GUTTER, MAKE THE DRAINAGE HOLE AND FOLD THE SIDE CREASES OF THE DRAINAGE GUTTER .

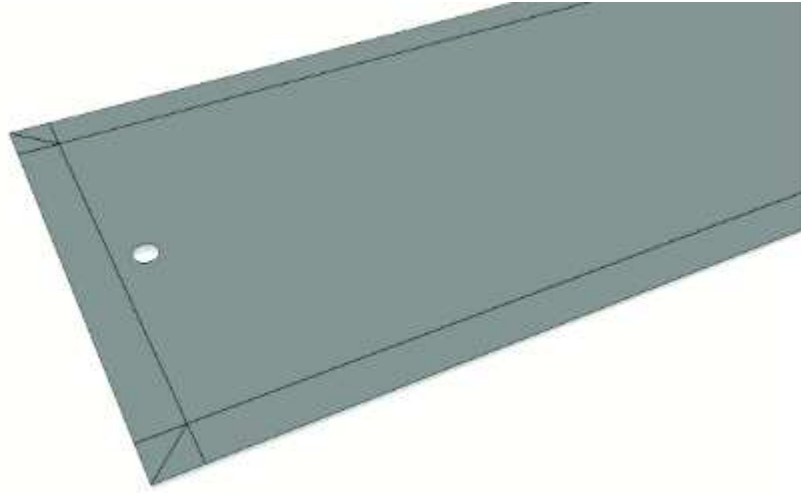

SECURE THE ENDS WITH THE RIVETS PROVIDED

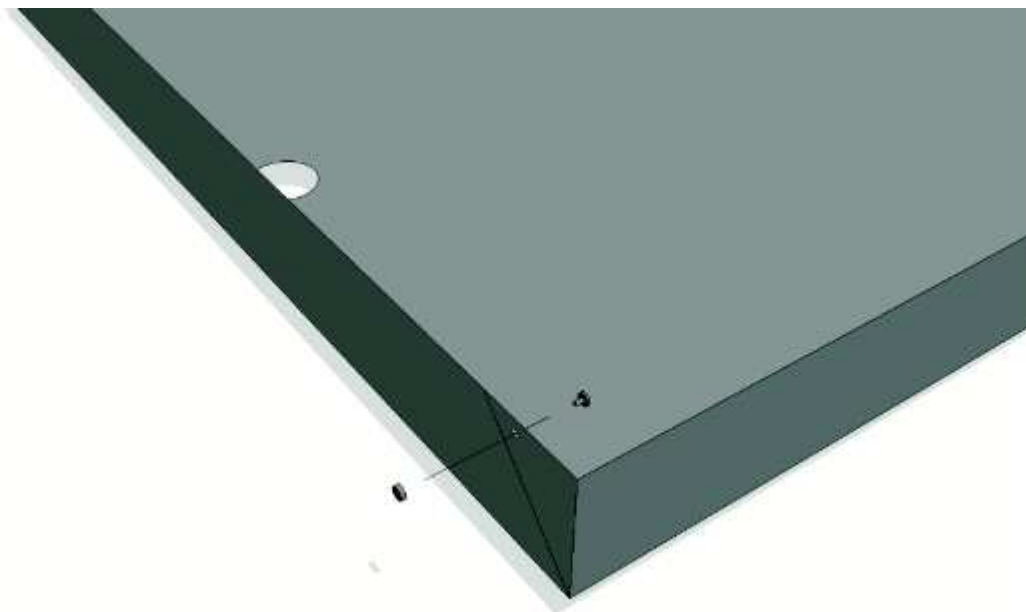

PLACE THE CLIPS ALONG THE SIDES OF THE DRAINAGE GUTTER

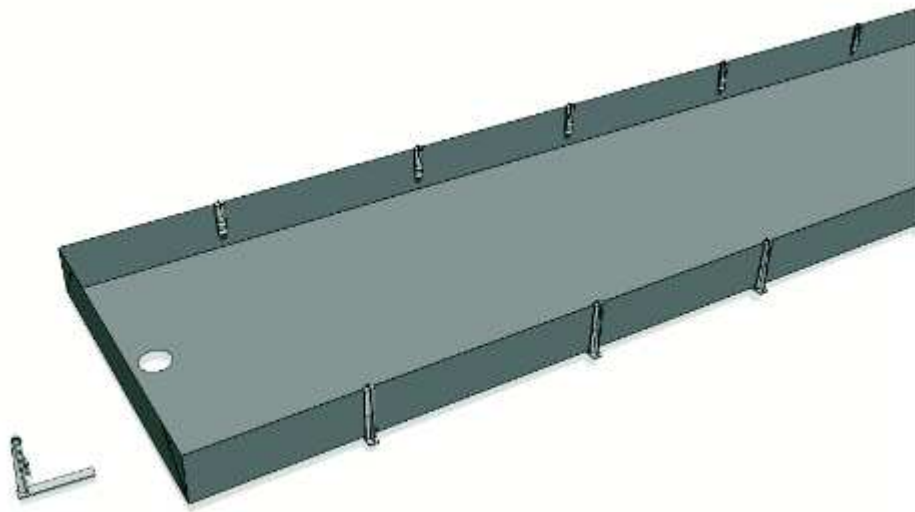

PLACE THE DRAINAGE SPACER INSIDE THE DRAINAGE GUTTER

