

## **TROUGH ENDINGS & RIVETS PLACING**

1. CRESE & FOLD THE CORNERS OF THE TROUGH



2. FOLD AT THE CREASES



3. MAKE HOLES FOR RIVETS



4. PLACE RIVETS IN THE HOLES

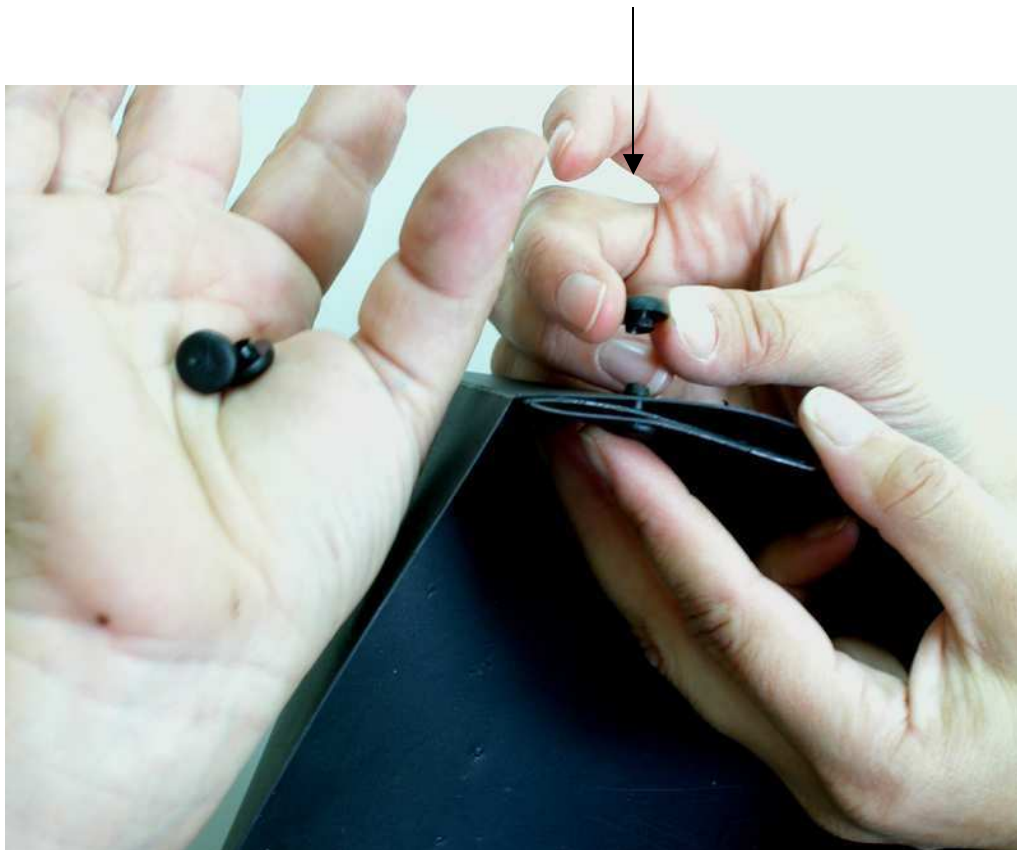

5. FINISHED TROUGH ENDING WITH RIVETS

